

# Case Study: ADI

## THE CHALLENGE

In the midst of the COVID-19 pandemic, ADI were keen to keep branches open while strictly following government safety guidelines.

This meant that they needed a way to control the number of people in their branches, to ensure that there was enough space inside to facilitate social distancing.

## THE SOLUTION

CDVI's innovative traffic light entry system met all of ADI's requirements for a safe, practical, and secure solution.

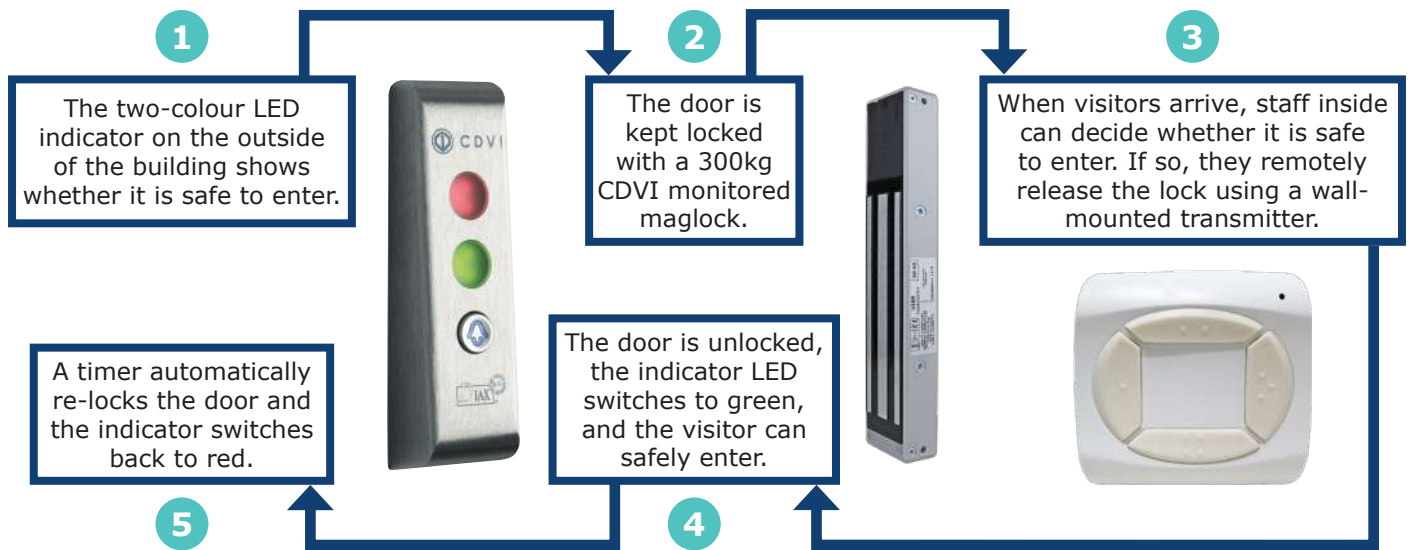

"In order to operate safely during the COVID-19 pandemic and easing out of lockdown, we needed a way to safely control access to our branches. We decided to implement CDVI's traffic light entry system. The red and green LED indicator makes it very clear when it is and is not safe to enter the building. Being able to control the door locking from inside has allowed us to manage capacity within the building and helped keep the risk of virus transmission to a minimum."

- Michael Lawrence, Regional General Manager - UKI, ADI Global Distribution